

Since 1995, we focus on switches

## DB-8 系列电源插座

Rating:

5A 250V AC T105  Approval

2.5A 250V AC  Approval

Insulation resistance: 1000MΩ(min)500V DC

Dielectric withstand voltage: 2500V AC 5s Between terminals

DB-8-7S1

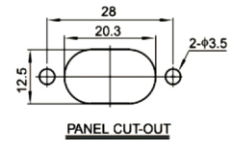
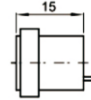
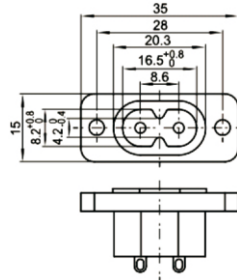

DB-8-8P2

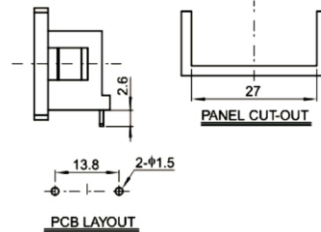
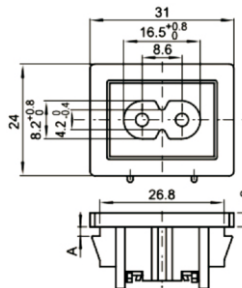
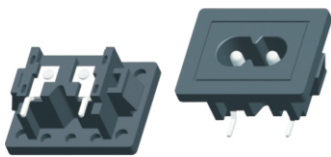

CODE	DIMENSION
A	0.8
	1
	1.5
	2

DB-8-9P9(G)

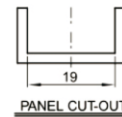
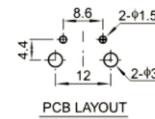
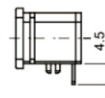
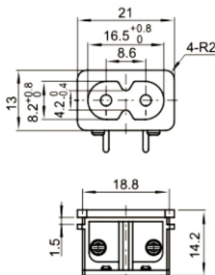

DB-8-11P23

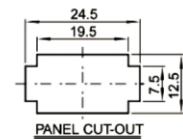
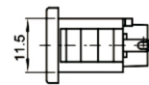
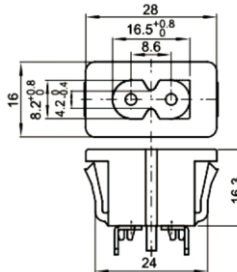

DB-8-12P9

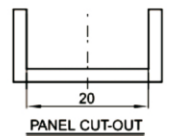
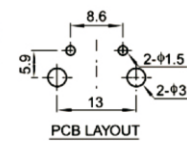
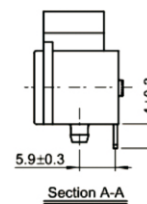
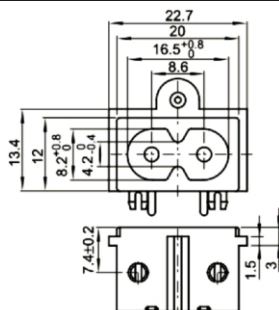

To provide a safe and reliable on-off service, let electric appliances more perfect